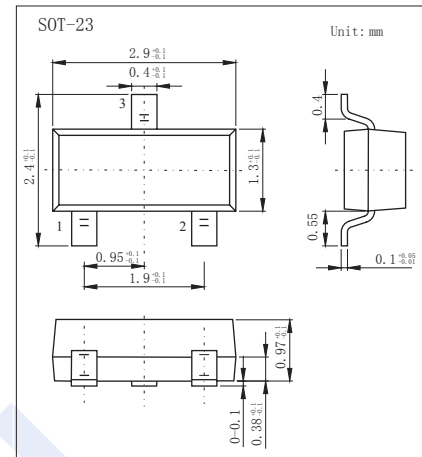
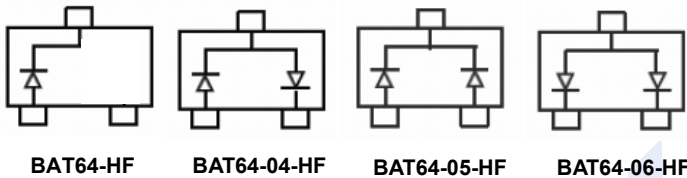

## Schottky Diodes

## BAT64-04/05/06-HF (KAT64-04/05/06-HF)

## ■ Features

- For low-loss, fast-recovery, meter protection, bias isolation and clamping applications
- Integrated diffused guard ring
- Low forward voltage
- Pb-Free Package May be Available. The G-Suffix Denotes a Pb-Free Lead Finish

■ Absolute Maximum Ratings  $T_a = 25^\circ\text{C}$ 

Parameter	Symbol	Rating	Unit
Peak Reverse Voltage	$V_{RM}$	40	V
DC Reverse Voltage	$V_R$	40	
Forward Current	$I_F$	250	mA
Non-repetitive Peak forward surge current @ $t=8.3\text{ms}$	$I_{FSM}$	800	
Power Dissipation	$P_D$	250	mW
Thermal Resistance Junction to Ambient	$R_{\theta JA}$	400	$^\circ\text{C}/\text{W}$
Junction Temperature	$T_J$	125	$^\circ\text{C}$
Storage Temperature range	$T_{stg}$	-55 to 150	

■ Electrical Characteristics  $T_a = 25^\circ\text{C}$ 

Parameter	Symbol	Test Conditions	Min	Typ	Max	Unit
Reverse breakdown voltage	$V_R$	$I_R = 100 \mu\text{A}$	40			V
Forward voltage	$V_F$	$I_F = 1 \text{ mA}$			350	mV
		$I_F = 10 \text{ mA}$			430	
		$I_F = 30 \text{ mA}$			520	
		$I_F = 100 \text{ mA}$			750	
Reverse voltage leakage current	$I_R$	$V_R = 25 \text{ V}$			2	$\mu\text{A}$
Capacitance between terminals	$C_T$	$V_R = 1 \text{ V}, f = 1 \text{ MHz}$		6		pF

## ■ Marking

Type	BAT64-HF	BAT64-04-HF	BAT64-05-HF	BAT64-06-HF
Marking	63S <sub>F</sub>	64S <sub>F</sub>	65S <sub>F</sub>	66S <sub>F</sub>

## Schottky Diodes

### BAT64-04/05/06-HF (KAT64-04/05/06-HF)

■ Typical Characteristics

